

**NIKO / ANIKO PLATFORM BED**

5480, 5479, 5478

Congratulations on the purchase of your Niko (Aniko) Platform Bed. This bed has been crafted to the highest standards of quality and safety and will give you many years of enjoyment and practical use.

On this insert you will find a list of the hardware and platform bed parts as well as detailed assembly instructions. Assembly is quite simple and requires only a flat head screwdriver and a Phillips head screwdriver. The use of a power drill with Phillips head attachment is helpful but not necessary. Assembly will be most easily accomplished if you take the time to carefully sort the hardware and familiarize yourself with the function of each piece.

If you need assistance with assembly, part replacement or any other matter, please contact the toll-free Epoch Design Customer Service Team from Monday through Friday, 9 AM-6PM PST at 1 (800) 589-7990. You may also email your request or comments to [info@epochbydesign.com](mailto:info@epochbydesign.com) and a customer service representative will respond.

**Thank you and Enjoy****HARDWARE LIST**

4x **110mm Bolts**  
Used to attach  
rails to headboard



2x **70mm Bolts**  
Used to attach  
drop support to  
center support

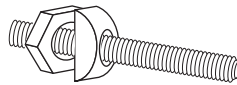

4x **Half Moon Bracket,  
Nut & Steel Dowel**  
Used to attach  
footboard to rails

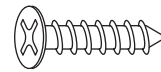

39x **Wood Screws**  
Used to attach  
slat bundle to rails

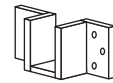

2x **Brackets**  
Used to attach  
headboard and  
footboard



12x **Machine Screws**  
Used to attach  
brackets

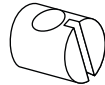

4x **Barrel Nuts**  
Used to tighten  
drop support



1x **Allen Wrench**  
Used to tighten  
center support bolts



1x **Wrench**  
Used to tighten  
footboard to rails

Guide

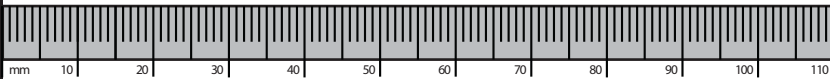
**BED PARTS**

1x **Drop Support**



2x **Side Rails**  
Used to connect  
end boards

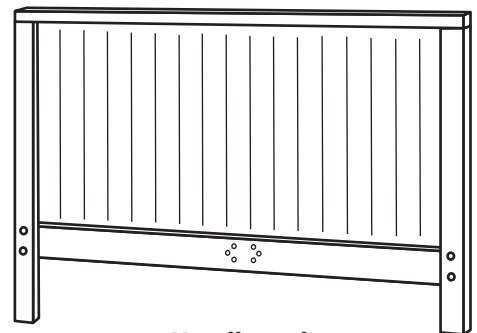

1x **Headboard**

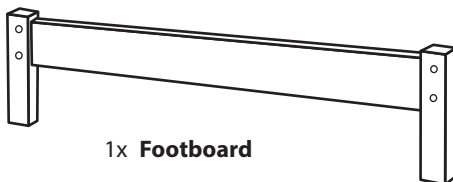

1x **Footboard**

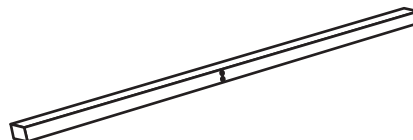

1x **Center Support**

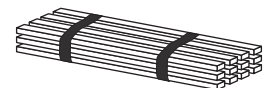

1x **Slat Bundle**  
rest on side rails and  
supports mattress  
(strap side down)

HAVE QUESTIONS OR CONCERNS? CALL US FIRST: 1-800-589-7990  
Activate your Epoch Design Limited Lifetime Warranty: [www.epochbydesign.com/register](http://www.epochbydesign.com/register)

- 1** Insert all four of the threaded steel dowels into the foot board by hand. Slide the footboard slat side in toward the side rails so that the dowels go through the holes at the end of the side rails.

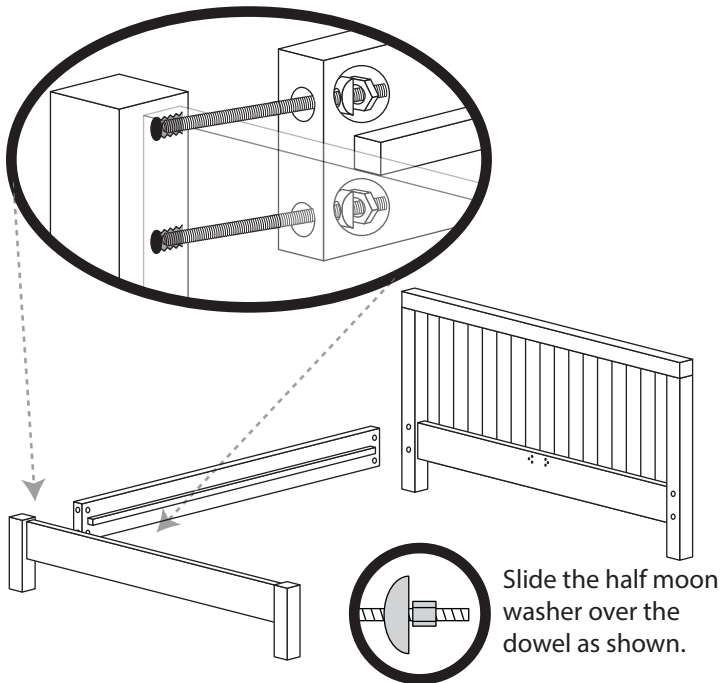

Hand tighten the nut behind the half moon washer. Repeat this process on the other side rail, then use the wrench provided to tighten the nuts evenly.

- 2** Using four 110mm bolts and four barrel nuts, attach the side rails to the headboard.

**Note:** Do one rail at a time and only hand tighten the bolts.

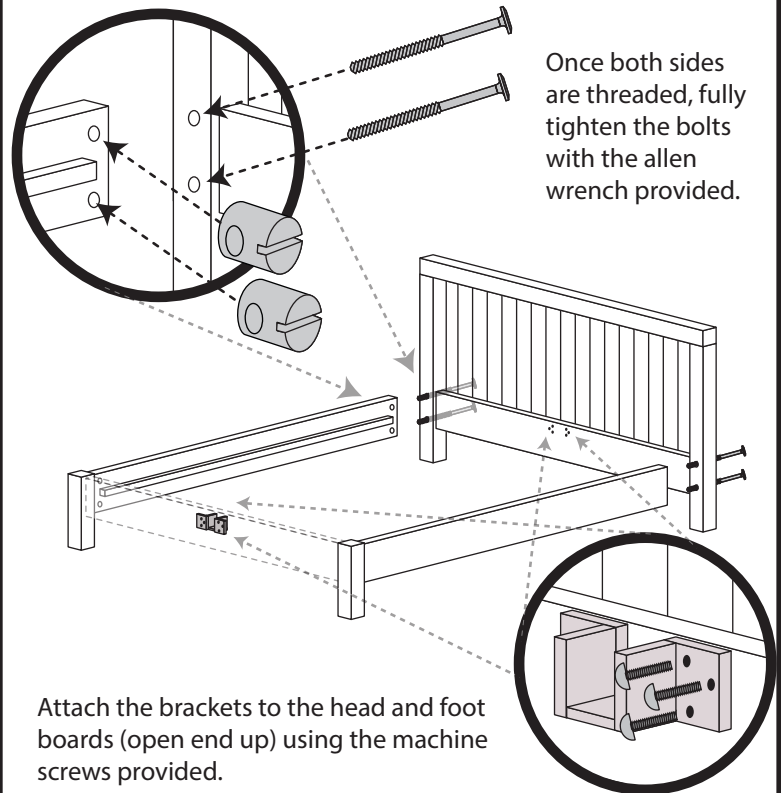

Once both sides are threaded, fully tighten the bolts with the allen wrench provided.

Attach the brackets to the head and foot boards (open end up) using the machine screws provided.

- 3** Attach the drop support to the center support by inserting two 70mm bolts through the drop support into the center support and tighten with the allen wrench provided.

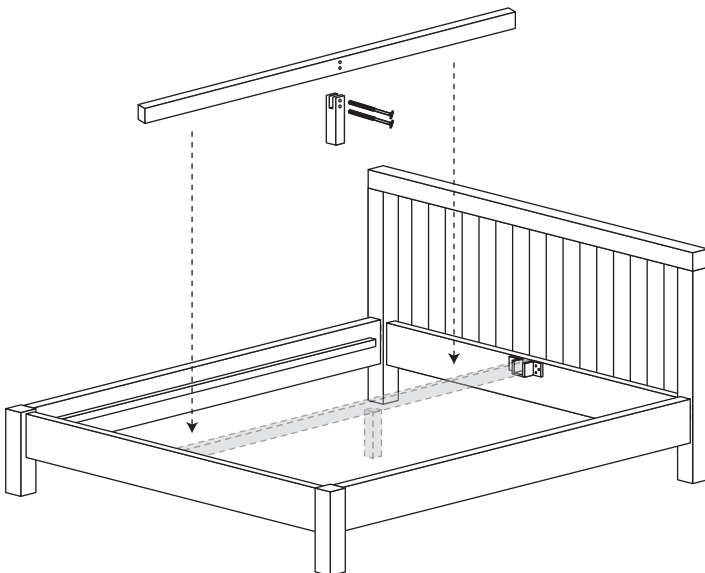

Lower the center support into the brackets.

- 4** Spread the slat bundle, strap side down, evenly across the side rails.

Secure the first slat on one end then the final slat on the other end, ensuring the slats are distributed evenly.

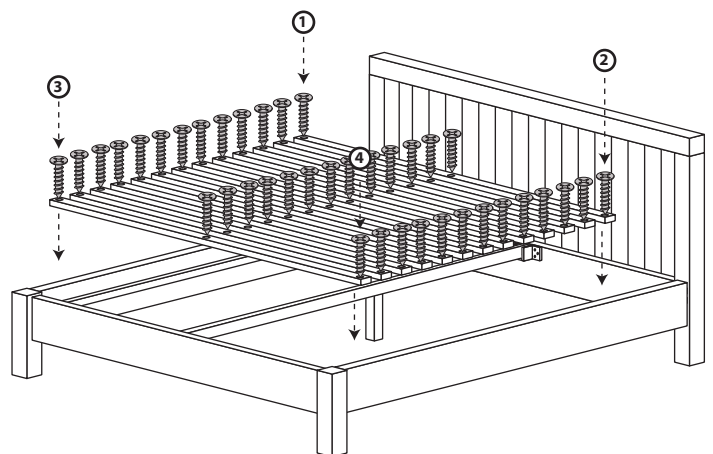

Use the remaining wood screws to secure all the slats to the side rails with a Phillips head screwdriver.

A power screwdriver with clutch set to low comes in handy for this step.