

Media Cart

5129: GA-OS-MC-NB

5141: GA-OS-MC-CO

Congratulations on the purchase of your Media Cart. This media cart has been crafted to the highest standards of quality and safety and will give you many years of enjoyment and practical use.

Since this media cart is a natural wood product, there will be variations in color and grain, and minor checking may occur. This is normal and does not compromise the integrity of your media cart. In fact, variation in character of solid hardwood is integral to the beauty and appeal of hardwood furniture, and distinguishes it from prefabricated, synthetic and composite materials.

On this insert you will find a list of the hardware and parts included as well as detailed assembly instructions. Assembly is quite simple and requires only a Phillips head screwdriver. Assembly will be most easily accomplished if you take the time to carefully sort the hardware and familiarize yourself with the function of each piece.

If you need assistance with assembly, part replacement, or any other matter, please contact the toll-free Epoch Design Customer Service Team from Monday through Friday, 9 AM-6PM PST at 1 (800) 589-7990. You may also email your request or comments to info@epochbydesign.com and a customer service representative will respond.

Thank you and Enjoy

HARDWARE LIST



10x **Camlock connector pins**



29x **15mm wood screws**

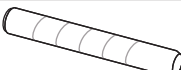

30x **30mm wooden dowels**



2x **Hinge pins**



10x **Camlocks**



6x **40mm screws**



2x **Keys**



2x **Caster wheels**



2x **Locking Caster wheels**

Guide

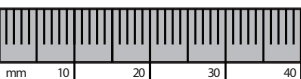

PARTS

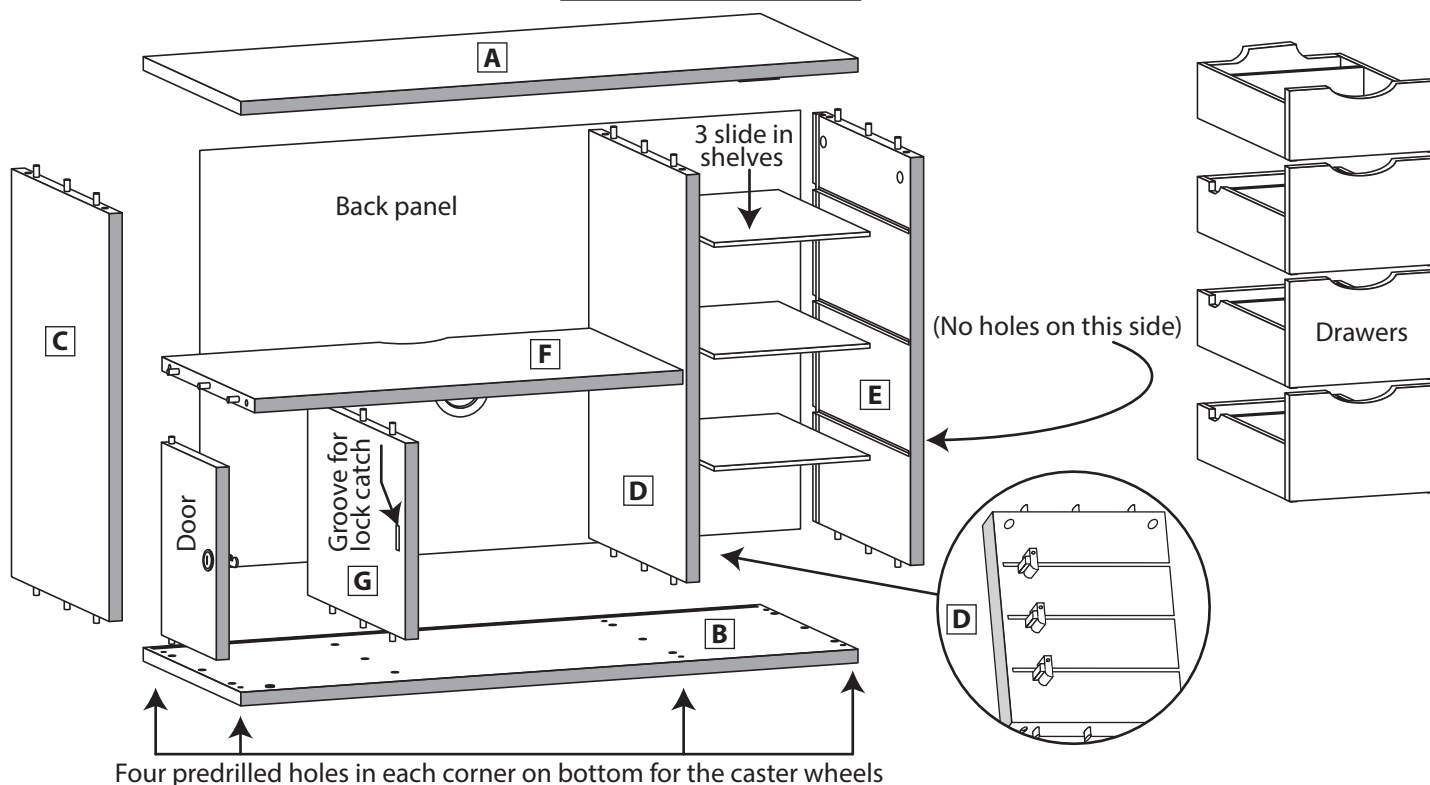

HAVE QUESTIONS OR CONCERNS? CALL US FIRST: 1-800-589-7990

Copyright © 2018 Epoch Design™ All rights reserved

- 1) Locate panels **A** **C** **D**. Insert camlock connector pins into the threaded inserts.

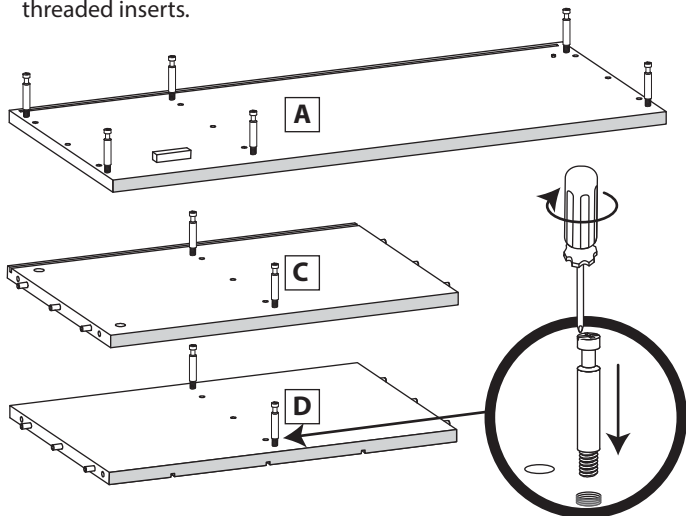

- 2) Insert the wooden dowels into **C** **D** **E** **F** **G**.

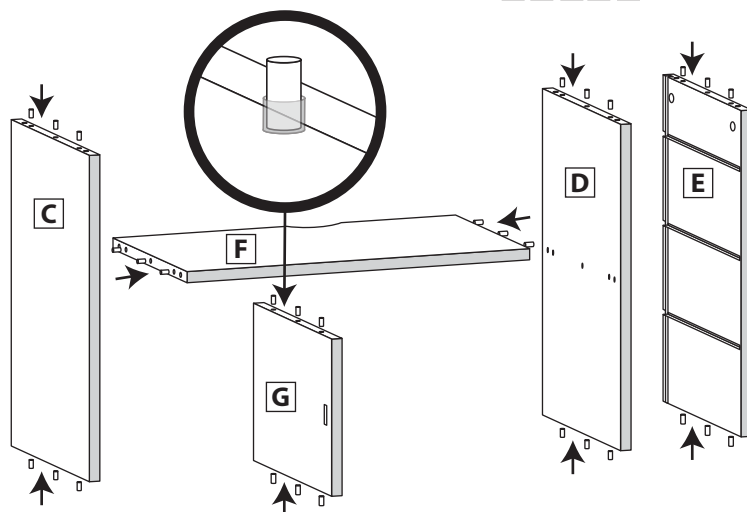

- 3) Place panel **D** on soft surface and locate panel **F**. Attach each panel so the finished edges are on the same side. Insert the pins into the corresponding holes in panel **F**. Secure panels by inserting one camlock into each of two corresponding holes on panel **F**. Turn each camlock clockwise about 1/4 turn or until gap between panels is gone. Do not over-tighten, it will damage the material.

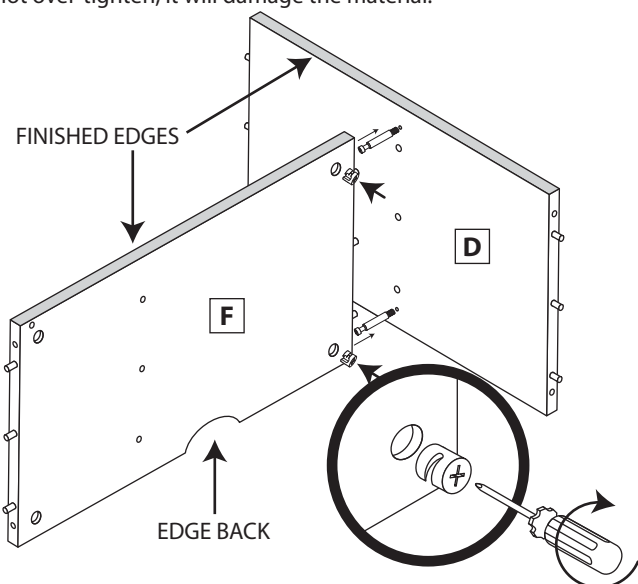

- 4) Locate panel **C** and attach with camlocks. Be sure the finished edges are on the same side.

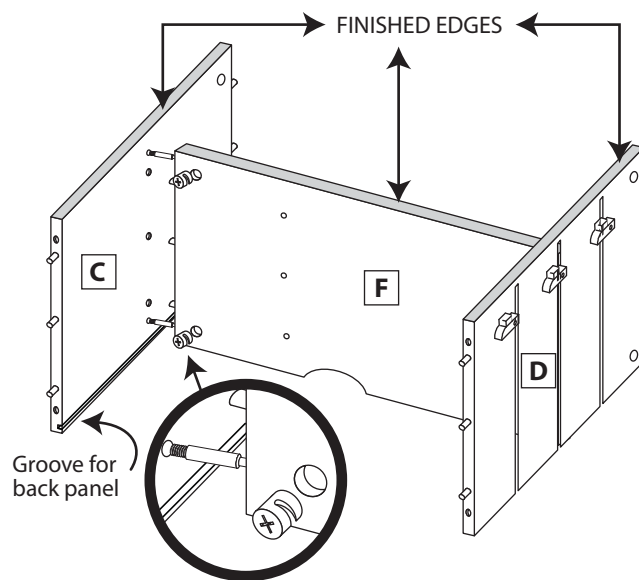

- 5) Locate panel **A** and join to the assembly using 4 camlocks

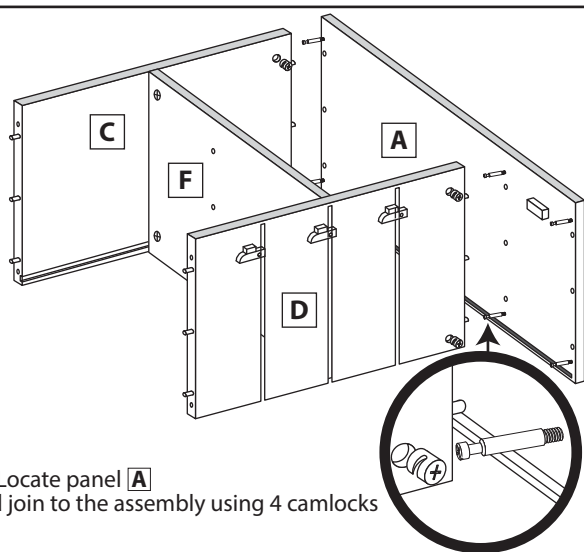

- 6) Attach panel **E** to panel **A** using two camlocks.

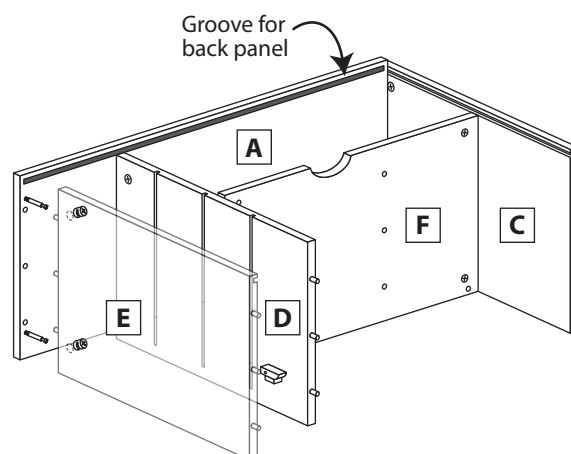

7) Insert panel **G** to panel **F**.

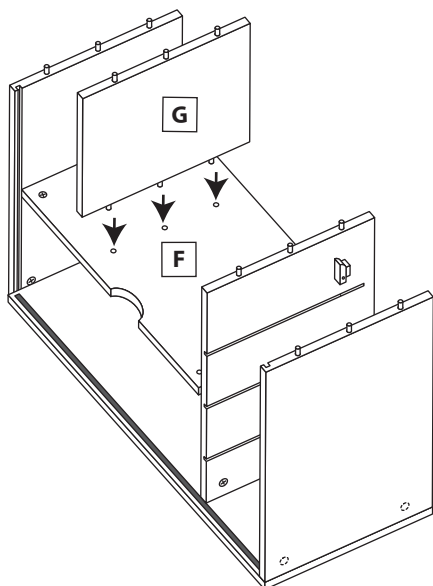

8) Slide the shelves into the precut slots on panel grooves **D** & **E**.

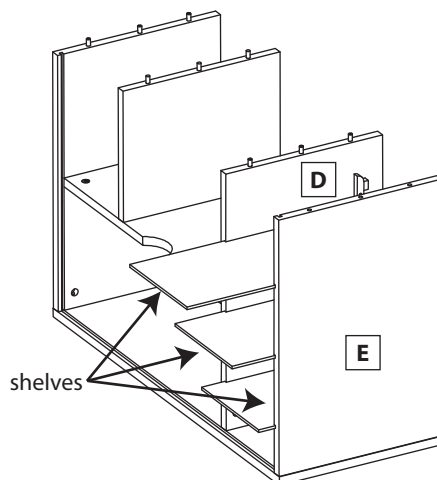

9) Slide the back panel into the groove on **C** & **E** with rubber ring closer to the "top".

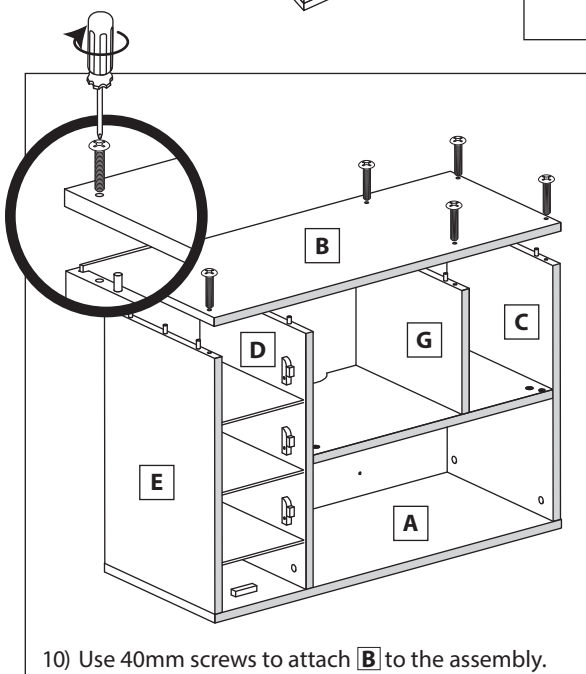
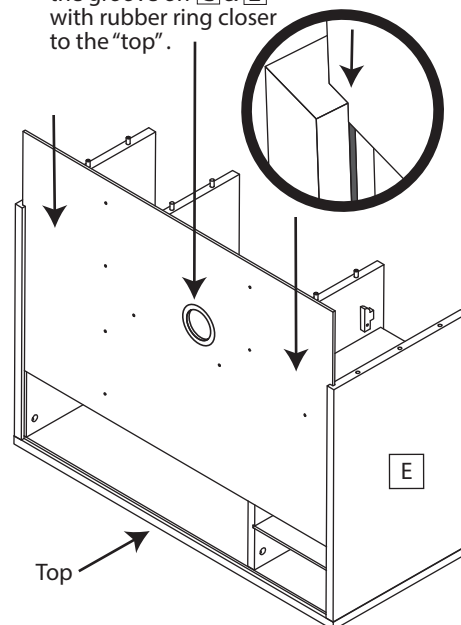

11) Use 15mm wood screws to secure the back panel.

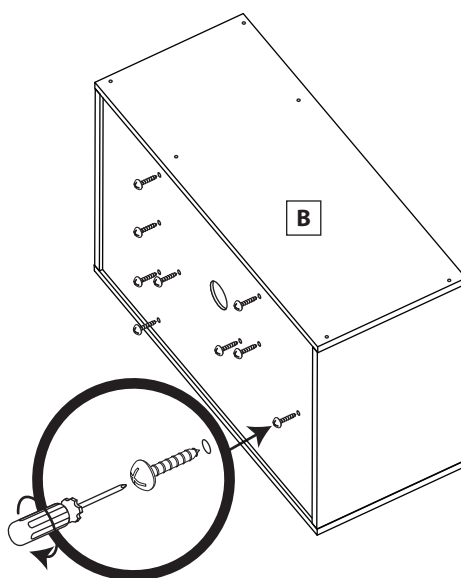

12) Use 15mm wood screws to attach the wheels to the bottom of the cart.

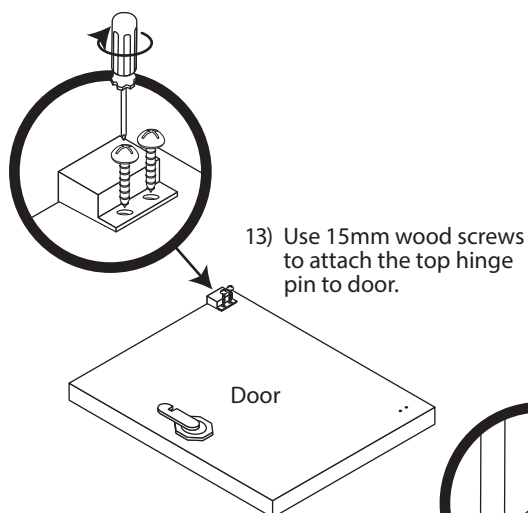
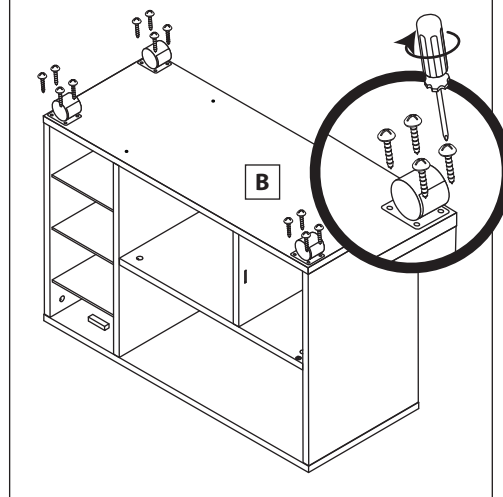

13) Use 15mm wood screws to attach the top hinge pin to door.

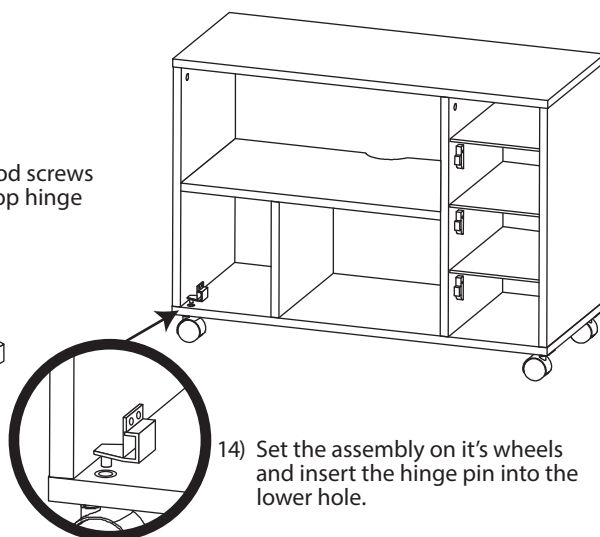

14) Set the assembly on its wheels and insert the hinge pin into the lower hole.

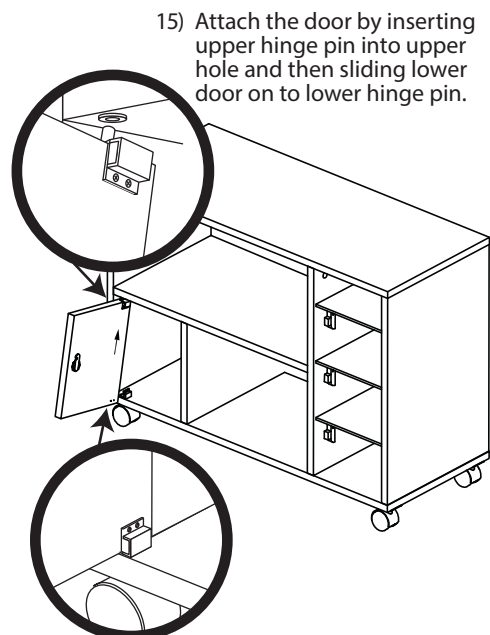

15) Attach the door by inserting upper hinge pin into upper hole and then sliding lower door on to lower hinge pin.

- 16) Use 15mm wood screws to attach the lower hinge pin to door.

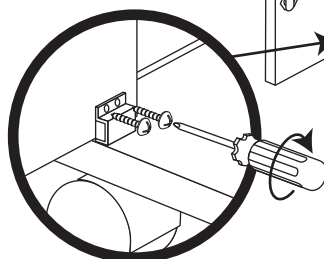

- 17) Insert the three larger drawers in the bottom three slots.

Note: The wood drawers stops will swing out of the way when the drawers are inserted, you can slide them back into the down position once they've been fully installed.

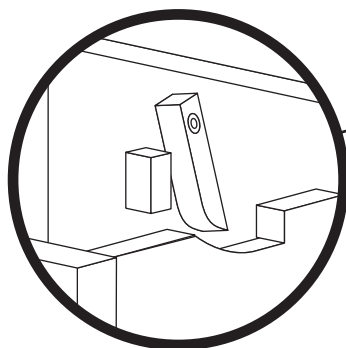

- 18) Locate the small drawer. It should be inserted at an angle so it will clear the wood block under the top panel. Tip the drawer up and slide it in until the tab on the drawer clears the wood block. Return the drawer to horizontal and finish insertion.

